



A World Away from the Ordinary!

THE CONDOMINIUMS AT KEYHOLE BAY

SEVILLE

BUILDING 4: TWO STORIES / SEVEN HOMES



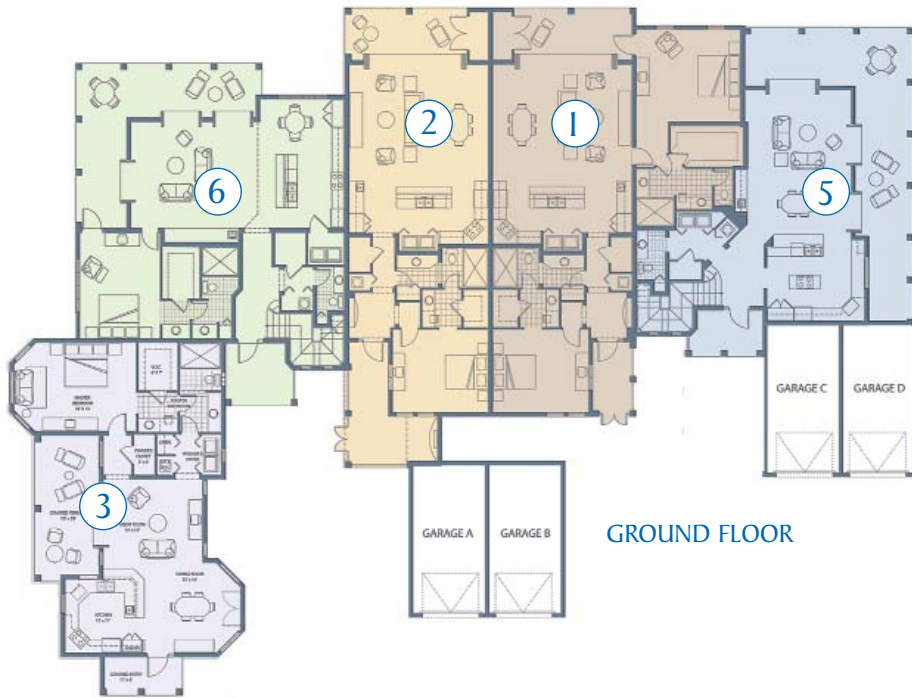

CONDOMINIUM SPECIFICATIONS:

- Majestic Mediterranean-style architecture.
- Solid masonry construction.
- 9 to 12 foot ceilings.
- Central air conditioning throughout.
- Designer décor ceiling fans.
- Quality-crafted windows and doors.
- Superior quality faucets and fixtures, exclusively from the Keyhole Bay Collection.
- Imported stone flooring.
- Fully-equipped kitchen featuring modern stainless steel oven, refrigerator and dishwasher.
- Full-sized washing machine and dryer.
- Top-of-the-line handcrafted wood cabinetry, both in the kitchen and bathrooms.
- Custom stone countertops.
- A compelling selection of furniture ensembles available to suit your personal taste and price range, exclusively from the Keyhole Bay Collection.

ONE BEDROOM (Units 2, 3 & 4)

- 1,400 sq ft (total gross area)
- 1,100 sq ft (air conditioned space)

TWO BEDROOM (Units 1 & 5)

- 1,900 sq ft (total gross area)
- 1,600 sq ft (air conditioned space)

- 2,700 sq ft (total gross area)
- 1,900 sq ft (air conditioned space)

THREE BEDROOM (Units 6 & 7)

- 3,000 sq ft (total gross area)
- 2,400 sq ft (air conditioned space)

- 3,900 sq ft (total gross area)
- 2,900 sq ft (air conditioned space)

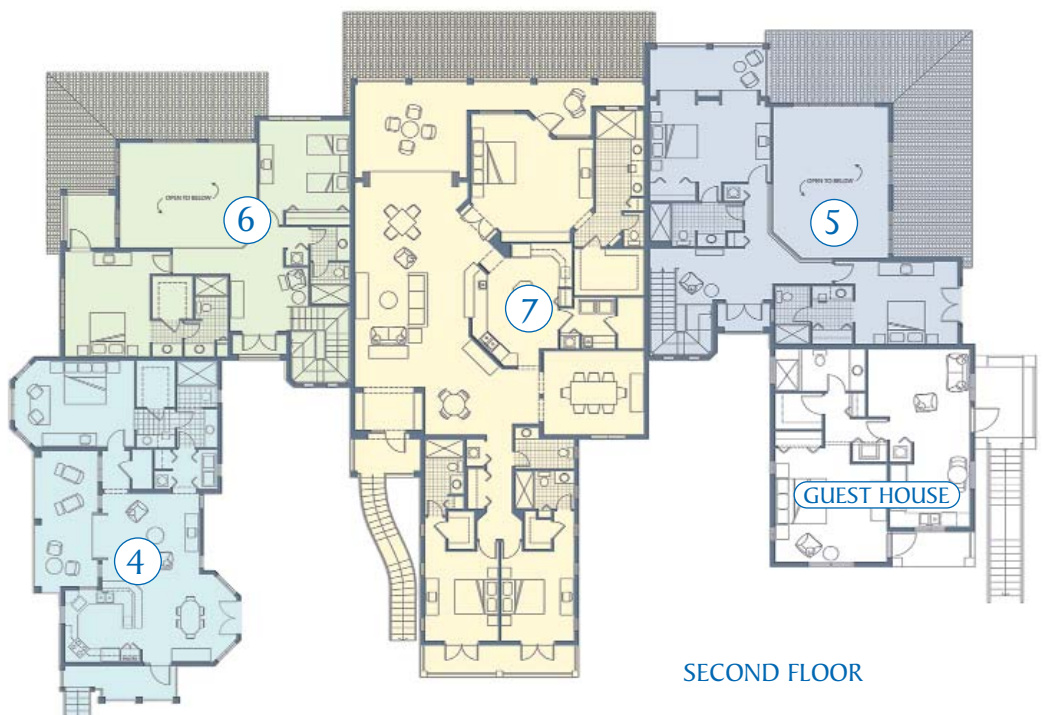

Keyhole Bay, Roatan, Bay Islands
 Honduras: 011 (504) 403-8036 or 8037
 U.S.A.: (228) 533-2001
info@keyholebay.com